

INVESTMENT OPPORTUNITY GREENWAY MALL



3500 - 3510B W 41ST STREET
SIOUX FALLS, SD 57106



ALL PROPERTY SHOWINGS ARE BY APPOINTMENT ONLY.

A COMPLETE COPY OF THE OFFERING MEMORANDUM & MARKETING MATERIALS CAN BE PROVIDED AFTER EXECUTION OF A FULL CA & NDA.

PLEASE CONTACT LLOYD COMPANIES FOR MORE INFORMATION.

The seller retains all rights and discretion regarding the offer and acceptance process, including the right to accept or reject any offer at their sole discretion. Seller will only be bound by duly executed and enforceable agreements, if any.

CONFIDENTIALITY AGREEMENT

The information in this Marketing Brochure is proprietary and strictly confidential. It is intended for review only by the recipient from Lloyd Real Estate, LLC DBA Lloyd Companies ("Lloyd Companies") and must not be shared with any other person or entity without Lloyd Companies' written consent. This brochure provides summary, unverified information to prospective buyers to establish preliminary interest in the property.

Lloyd Companies has not investigated and makes no warranty or representation regarding the income or expenses for the property, projected financial performance, dimensions of the subject property, compliance with regulations, the condition of improvements, or the financial status or plans of any tenant. The information has been sourced from what we believe are reliable sources; however, Lloyd Companies has not verified and will not verify any of the information provided and makes no representation or warranty regarding its accuracy or completeness. Potential buyers must verify all information.

The information provided is for informational purposes only and does not constitute legal advice. It represents only part of the comprehensive information available and is intended for preliminary review. Prospective buyers are strongly encouraged to thoroughly review all relevant documents and seek professional real estate, financial, and legal advice to comprehend their rights and obligations. Reliance on the information without proper legal review is at the individual's own risk.

NON-ENDORSEMENT NOTICE

Lloyd Real Estate, LLC DBA Lloyd Companies is not affiliated with, sponsored by, or endorsed by any commercial tenant or lessee mentioned in this marketing brochure. The appearance of corporate logos or names does not imply affiliation or endorsement by the corporation of Lloyd Companies, its employees, subsidiaries, agents, products, services, or commercial listings. This information is included solely to provide tenant lease details to prospective customers.

Investment Facts



Lloyd Companies is pleased to present Greenway Mall as an investment opportunity near the intersection of 41st Street & Louise Avenue. The offering includes two vacant suites, available now, opening up potential for an owner-occupant investor to establish a presence while benefiting from existing income. Current tenants include Firehouse Subs, The Cell Phone Guy, Metro by T-Mobile, Chasing Clouds Vape, a beauty supply store, and DXL Big & Tall, providing a stable and diverse retail mix. Greenway Mall is positioned within a low-vacancy retail corridor surrounded by national anchors such as Target, Barnes and Noble, and Chick-fil-A. The property also offers a dedicated center turning lane into the parking lot and two full access points. Greenway Mall presents an attractive combination of stability, visibility, and value-add potential for investors.

- **Address:**
3500 - 3510B W 41st Street, Sioux Falls, SD 57106
- **County:**
Minnehaha
- **Pricing:** \$3,450,000
- **Price / SF:** \$141.43
- **Real Estate Taxes:**
\$33,426.18 (2025 Taxes payable in 2026)
- **Net Rentable Square Footage (RSF):**
24,394 SF +/-
- **Vacant Square Footage:**
4,360 SF +/-
- **Site Size:**
1.47 Acres +/-
- **Year Built:** 1985
- **Zoning:** C-4
- **Proforma Cap. Rate:**
8.96%

- **Parking:**
60 shared surface stalls
- **Signage:**
Pylon & building
- **Current Number of Tenants:**
7 of 9
- **Occupancy Rate:**
82.1%

- **Utility Information:**

Utility	Paid By	Provider	Part of CAM	Separately Metered
Gas	Paid by Tenant directly to Provider	Mid-American Energy	No	Yes
Electricity	Paid by Tenant directly to Provider	Xcel Energy	No	Yes
Water & Sewer	Paid by Tenant through CAM	City of Sioux Falls	Yes	No
Trash	Paid by Tenant through CAM	Novak	Yes	No
Phone/Cable/Internet	Paid by Tenant directly to Provider	Tenant can select their preferred provider	No	N/A

Parcel Overview



3500 - 3510B W 41st Street, Sioux Falls, SD 57106



Tenant Overview



3500 - 3510B W 41st Street, Sioux Falls, SD 57106

DCP Connection Beauty Supply

DCP Connection Beauty Supply is a family-owned and operated beauty supply store dedicated to providing high-quality hair products and supplies.

Address: 3500 W 41st Street

Gross Leasable Area: 2,880 SF +/-

Pro Rata Share of Project: 11.81%

Number of Locations: 1

Headquarters: Sioux Falls, SD

Year Founded: 2025



Metro by T-Mobile is a nationwide pre-paid wireless brand offering no-contract phone plans, smartphones, and 5G coverage through its parent company.

Address: 3502 W 41st Street

Gross Leasable Area: 1,129 SF +/-

Pro Rata Share of Project: 4.63%

Number of Locations: 6,374

Headquarters: Richardson, TX

Year Founded: 1994



DXL Big & Tall is a specialty men's retailer proving an extensive selection of high-quality, stylish clothing designed for larger and taller builds.

Address: 3502A W 41st Street

Gross Leasable Area: 6,093 SF +/-

Pro Rata Share of Project: 25.00%

Number of Locations: 296

Headquarters: Canton, MA

Year Founded: 1976



Firehouse Subs is a fast-casual sandwich chain known for its freshly prepared hot subs and commitment to quality ingredients.

Address: 3504B W 41st Street

Gross Leasable Area: 1,935 SF +/-

Pro Rata Share of Project: 7.94%

Number of Locations: 1,360

Headquarters: Jacksonville, FL

Year Founded: 1994



The Cell Phone Guy is a locally trusted electronics retail and repair shop specializing in fast, reliable service for smartphones, tablets, and other devices.

Address: 3506 W 41st Street

Gross Leasable Area: 1,975 SF +/-

Pro Rata Share of Project: 8.02%

Number of Locations: 1

Headquarters: Sioux Falls, SD

Year Founded: 2009



Chasing Clouds Vape is a family owned and operated vape and smoke retailer with multiple locations, knowledgeable staff, and a curated product lineup.

Address: 3510 W 41st Street

Gross Leasable Area: 4,380 SF +/-

Pro Rata Share of Project: 17.96%

Number of Locations: 20

Year Founded: 2020



Fox Pest Control is a professional pest management company providing safe, timely, and effective solutions for homes and businesses.

Address: 3510B W 41st Street

Gross Leasable Area: 1,642 SF +/-

Pro Rata Share of Project: 6.74%

Number of Locations: 30+

Headquarters: Logan, Utah

Year Founded: 2012

Available Suites

Suite	Size (Usable)	Size (Rentable)	Base Rent	2026 NNN Est.	Total (Base + NNN) Est.	Yearly Total Est.	Monthly Total Est.
3508	2,248 USF +/-	2,346 RSF +/-	\$14.00/SF NNN	\$6.92/SF	\$20.92/SF NNN	\$49,078.32	\$4,089.86
3508-100	1,917 USF +/-	2,014 RSF +/-	\$14.00/SF NNN	\$6.92/SF	\$20.92/SF NNN	\$42,132.88	\$3,511.07

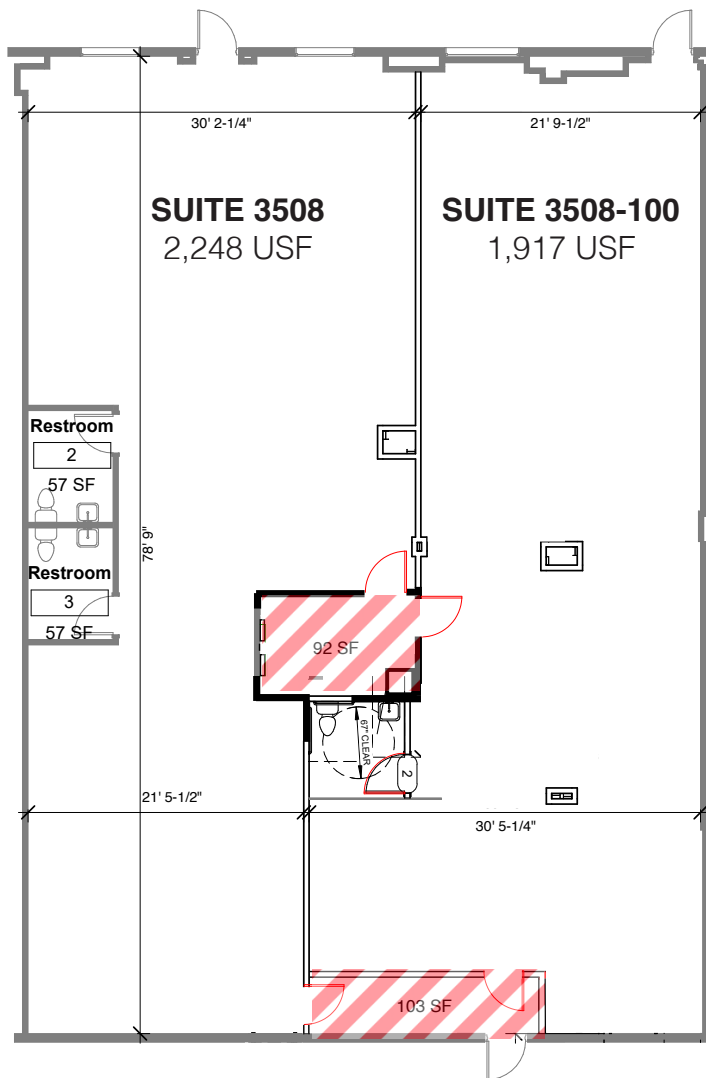

Exterior Photos



Site Map



*Empire Shopping District includes The Empire Mall, Empire Place, & Empire East

Visitor Data



132K

visits in the past 12 months

66.3K

visitors in the past 12 months

20 min

Average Dwell Time

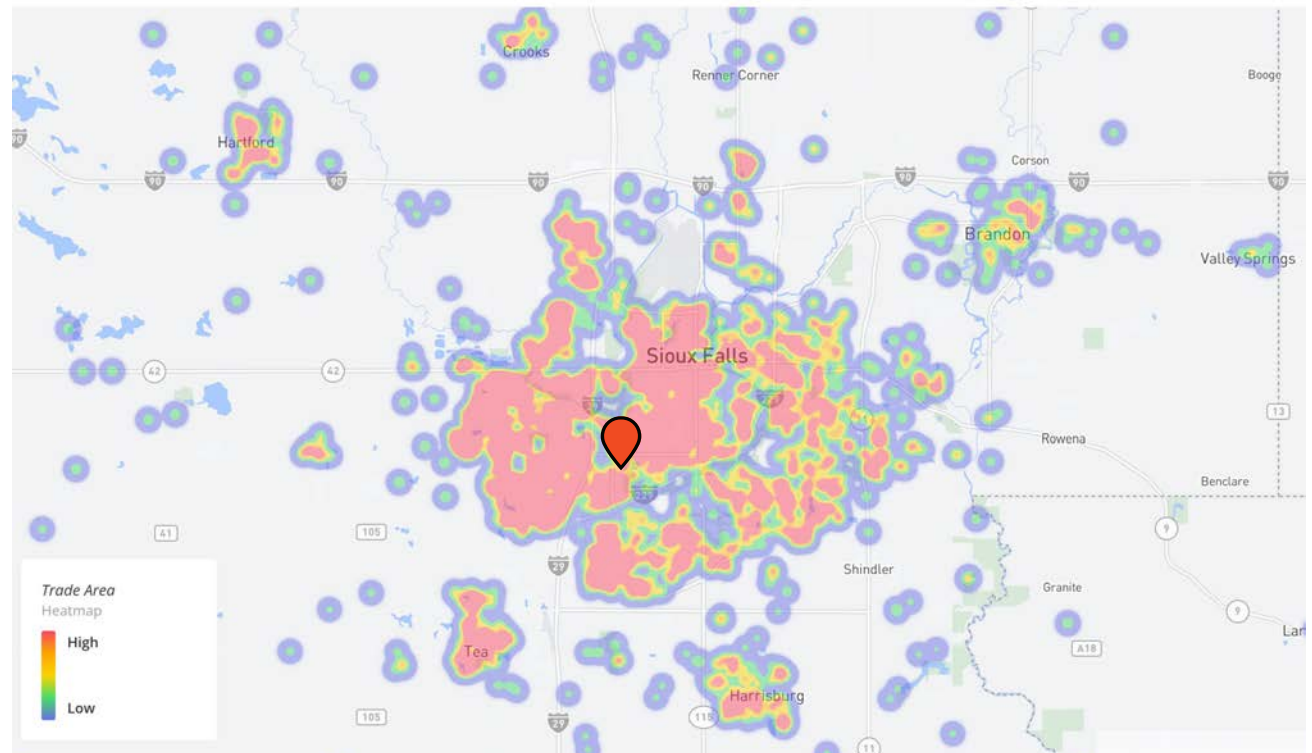

2025 AREA DEMOGRAPHICS

	1 mile	3 miles	5 miles	MSA
Total Population	9,220	95,803	177,443	311,500
Projected Population (2030)	9,626	102,893	192,568	336,494
Daytime Population	18,508	109,632	199,799	311,087
Median Age	41.6	36.8	36.7	36.4
Area Households	4,990	40,278	73,148	122,443
Median Household Income	\$47.9k	\$75.6k	\$77k	\$80k
Median Home Value	\$244k	\$298k	\$304k	\$301k
Educational Attainment (Associates Degree +)	43.3%	53.9%	53.4%	53.2%

Demographics

Sioux Falls, South Dakota's largest city, is one of the fastest growing areas in the nation with population growth rate nearly four times the national average. It serves as the largest retail hub between Denver and the Twin Cities and offers residents & visitors an ample selection of commodities and services. Being located in the heart of the Midwest, Sioux Falls draws shoppers from a four-state area. Employment across the state is projected to increase by 7.7% by 2032, further solidifying its reputation as an economic leader.

Sioux Falls has low business costs with a high quality of life. There's no state, corporate or personal income tax, no inheritance tax and no limits to what your business can achieve.

POPULATION PROJECTION		
Year	Sioux Falls	MSA
2025	224,676*	314,596
2030	235,786	341,319

*Source: The City of Sioux Falls

FAST FACTS



#1 City for Small Businesses
(B2B Review 2025)



#2 Best Tax Climate in the U.S.
(Tax Foundation 2024)

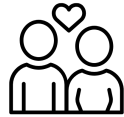

#6 Best City for Young Couples
(StorageCafe 2026)



Top 25 Safest Cities in America
(WalletHub 2025)



#1 Corporate Site Selection Per Capita (Tier 2 Metros)
(Site Selection 2025)

2.3%

Sioux Falls MSA Unemployment Rate
(December 2025)



No Corporate Income Tax



#7 Best Run Cities in America
(WalletHub 2025)

TOP EMPLOYERS



10,929



8,200



3,627



3,239



2,390



1,600

Sioux Falls Major Attractions



The Falls
1.2M Annual Visits

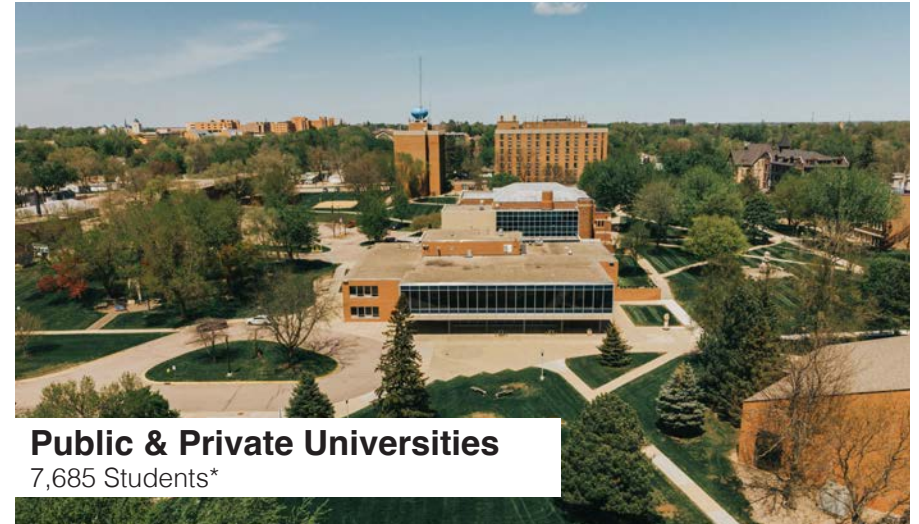

Public & Private Universities
7,685 Students*

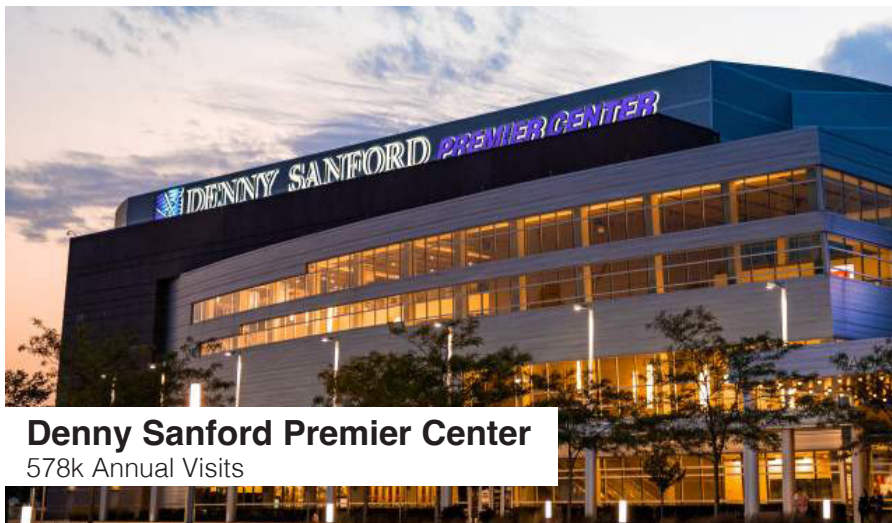

Denny Sanford Premier Center
578k Annual Visits



Sanford Sports Complex
2.5M Annual Visits

Student count for the 2025-2026 academic year includes both full-time and part-time students. Data provided directly by the respective universities. The data on this page has been obtained by a third party provider and is based on tracking data from mobile/cellular devices. Lloyd Companies makes no warranty or representation whatsoever regarding the accuracy or completeness of the data provided. All prospective buyers must take appropriate measures to verify all the information set forth herein.

INVESTMENT OPPORTUNITY
GREENWAY MALL

3500 - 3510 W 41ST STREET
SIOUX FALLS, SD



SCOTT BLOUNT

BROKER ASSOCIATE

scott@lloydcompanies.com

605-231-1882

150 E. 4th Place | Suite 600 | Sioux Falls, SD 57104
605.323.2820 | LloydCompanies.com

Property details contained herein are intended for general informational purposes only. Lloyd Real Estate, LLC has not independently verified the provided information and makes no representation or warranty of any kind regarding its accuracy or completeness. Traffic, visit, and sale data within this document, sourced from a third-party provider, is based on tracking data from mobile/cellular devices. Use this information at your own discretion, and always consult with qualified professionals or experts in the relevant field for specific guidance. All interested parties are advised to take appropriate measures to verify all information set forth herein. Nothing contained herein shall be deemed to constitute legal, financial, or professional advice.